

WARNING + SAFETY INFORMATION

▶ DANGER: HIGH VOLTAGE Electric shock could result in death or injury. Please consult qualified personnel for installation.

This manual is to serve the purpose of providing recommendations for proper performance but is not to supersede or replace local or national electric codes. Installation should be done by a licensed electrician.

MOUNTING + KNOCKOUT DIMENSIONS

(All dimensions in inches.)

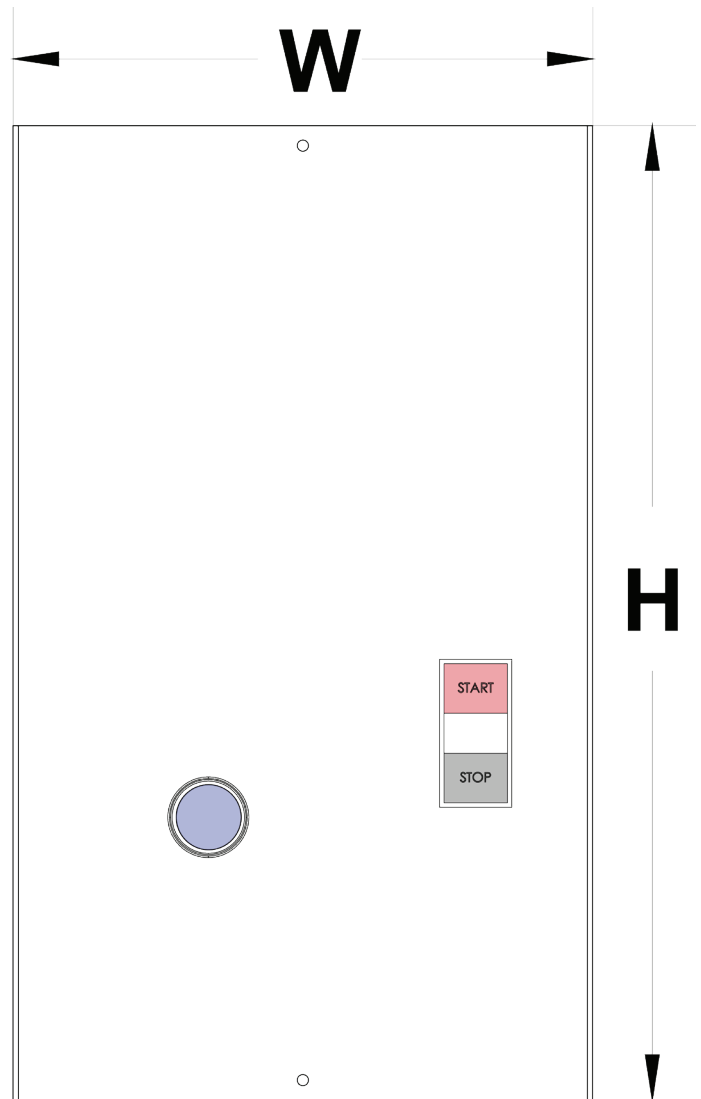
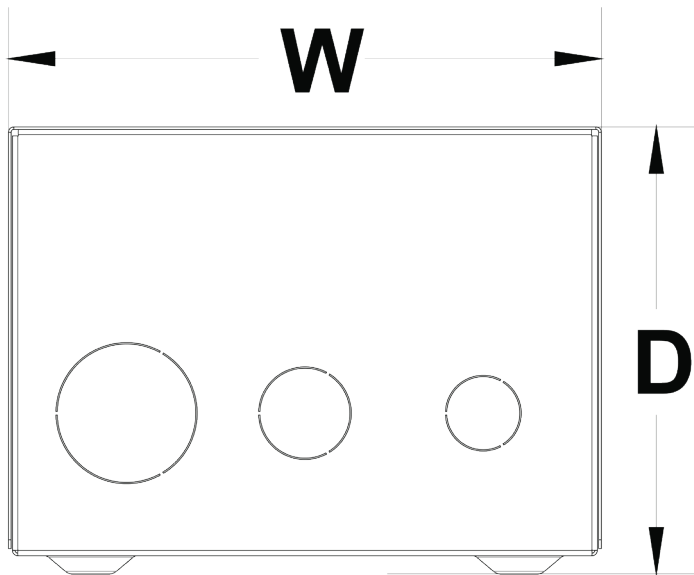

| PANEL PART # | HEIGHT (H) | WIDTH (W) | DEPTH (D) |
|----------------|------------|-----------|-----------|
| MS58-MS2332 | 9.5 | 5.18 | 4.4 |
| MS3750-MS90150 | 14 | 8.31 | 6.27 |

| PANEL PART # | KNOCKOUTS |
|----------------|----------------------|
| MS58-MS2332 | (1)1/2 (1)3/4 |
| MS3750-MS90150 | (1)3/4 (1)1 (1)1-1/2 |

INSTALLATION + OPERATION GUIDE

INSTALLATION

Disconnect incoming power before installing.

Mount the starter panel, allowing enough space to install wires from the input and output to the load. Connect the incoming wires to terminals 1L1, 3L2, and 5L3 of the contactor. Make sure any existing control wires in these terminals remain. Connect the load to terminals 2T1, 4T2, and 6T3.

SETTING THE OVERLOAD

Turn the dial on the overload relay to match the FLA rating of the motor that will be controlled by the starter panel. Reconnect the power supply.

OPERATION

If equipped with a start/stop button, these will control the operation of the load that is connected to the motor starter. If an overload situation occurs, the blue reset button can be used to reset the overload once the cause of the overload has been corrected.

NO START/STOP SWITCH

If no start/stop button is present, the motor starter will only protect against overload situations and cannot be used to control the load. The contactor will close and start the load as soon as incoming power is supplied.

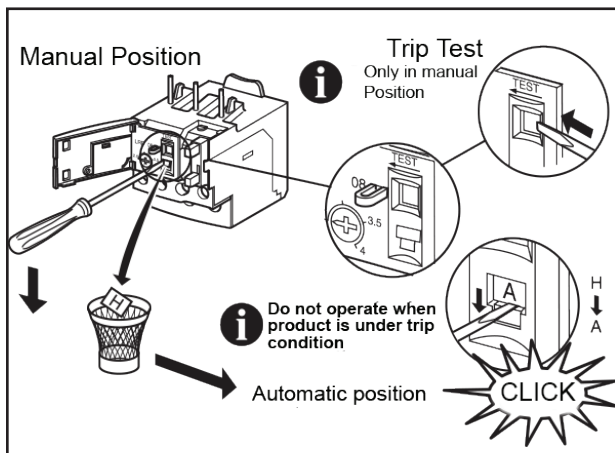
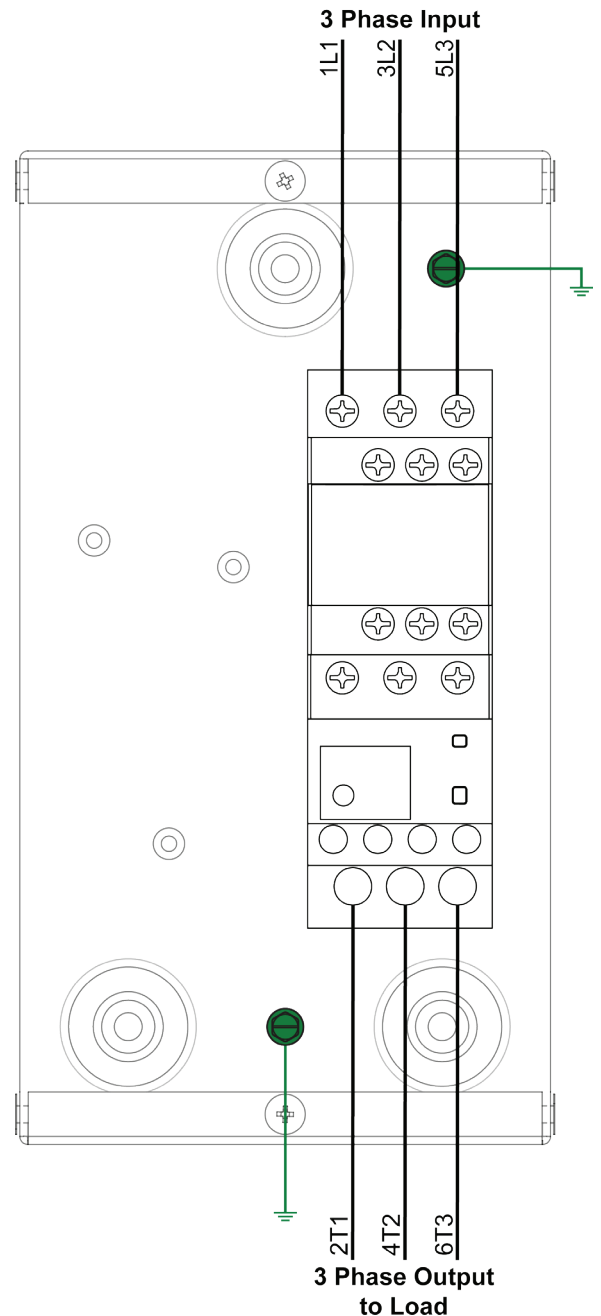

PERFORMING TRIP TEST

Trip test will only function in the manual reset position. Slide the black indicator located under "TEST" from right to left. The letter "T" will appear and stay visible until the blue reset button is pushed.

AUTOMATIC RESET

If your starter needs to reset automatically after an overload event, pop off the tab located between letters "H" and "A" in the test area and discard. Slide the blue tab towards 'A' until it clicks.

INCOMING

| VAC | FLA | PANEL PART NUMBER | MIN LOAD (AMPS) | MAX LOAD (AMPS) | LARGEST MOTOR | CONTACTOR (M1) | OVERLOAD RELAY (OL) |
|-----|-----|-------------------|-----------------|-----------------|---------------|----------------|---------------------|
| 240 | 8 | MS-58 | 5 | 8 | 2HP | LC1D12U7 | LR3D12 |
| 240 | 10 | MS-710 | 7 | 10 | 3HP | LC1D12U7 | LR3D14 |
| 240 | 18 | MS-1218 | 12 | 18 | 5HP | LC1D18U7 | LR3D21 |
| 240 | 24 | MS-1624 | 16 | 24 | 7.5HP | LC1D25U7 | LR3D22 |
| 240 | 32 | MS-2332 | 23 | 32 | 10HP | LC1D32U7 | LR3D32 |
| 240 | 50 | MS-3750 | 37 | 50 | 15HP | LC1D50U7 | LR3D350 |
| 240 | 65 | MS-4865 | 48 | 65 | 20HP | LC1D65AU7 | LR3D365 |
| 240 | 80 | MS-6380 | 63 | 80 | 25HP | LC1D80U7 | LR3D3363 |

WARNING

Disconnect power before proceeding with any work on this equipment. Installation and maintenance by electrical technician only. Follow your national, regional and local codes when operating.

NOTES

Copper Wire Required at 75°C.

Disconnect and Branch circuit protection provided by others.

TORQ

WIRE AWG

| MODEL | LB-IN | LINE | LOAD |
|---------|-------|-------|--------|
| MS-58 | 15 | 10-18 | 10-18 |
| MS-710 | 15 | 10-18 | 10-18 |
| MS-1218 | 15 | 8-18 | 10-18 |
| MS-1624 | 22 | 6-14 | 8-18 |
| MS-2332 | 22 | 6-14 | 8-18 |
| MS-3750 | 70 | 2-16 | 2-18 |
| MS-4865 | 70 | 2-16 | 2-18 |
| MS-6380 | 100 | 2-10 | 1/0-10 |

3-PHASE INPUT

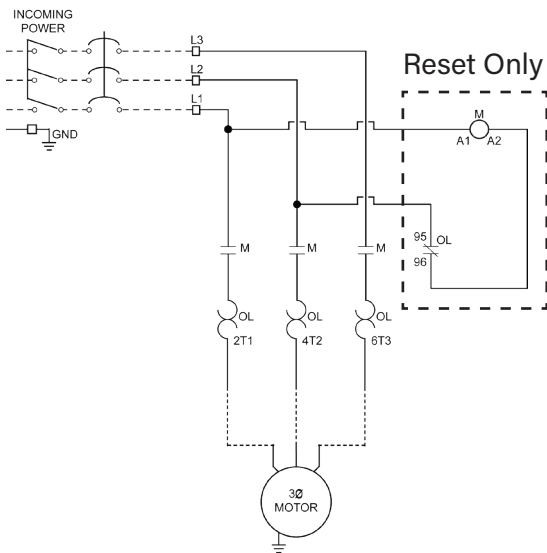

START-STOP BUTTON (OPTIONAL)

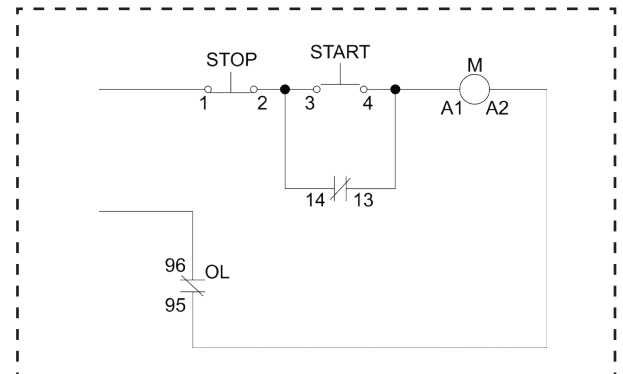

CONFIDENTIAL

THIS DOCUMENT IS THE PROPERTY OF GENTEC LLC
 SUBJECT MATTER HERE IN IS CONFIDENTIAL. DO NOT
 USE, REPRODUCE, COPY OR DISCLOSE EXCEPT WITH
 WRITTEN CONSENT OF GENTEC LLC
 ©2021 GENTEC LLC

GENTEC LLC

UL FILE: 329389

NOT TO SCALE

DWG NO
 MS58-6380-UL-240V

REV
 --

SHEET 1 OF 1

WARRANTY

MOTOR STARTER WARRANTY

All American Rotary motor starter control panels are warranted against defects in material and workmanship for 1 year. American Rotary will repair or replace (at our option), at no charge, any part(s) found to be faulty during the warranty period specified. The motor starter warranty repairs must be performed by/at American Rotary's facility.

OBLIGATIONS OF THE ORIGINAL OWNER

Transportation of motor starter to American Rotary is the responsibility of the original purchaser. Return transportation is provided by American Rotary when the control panel is "in-warranty."

EXCLUSIONS OF THE WARRANTY

This warranty does not cover any of the following: accident, misuse, fire, flood, and other acts of God, acts of terrorism, nor any contingencies beyond the control of American Rotary, including but not limited to water damage, incorrect line voltage, improper installation, installation where this unit will not meet local electrical codes, missing or altered serial numbers, and service performed by an unauthorized facility. American Rotary's liability for any damages caused in association with the use of American Rotary's' equipment shall be limited to the repair or replacement only of the American Rotary's' equipment. No person, agent, distributor, dealer, or company is authorized to modify, alter, or change the design of this merchandise without express written approval of American Rotary.

Liability Limitation: In no event shall American Rotary be liable or responsible for consequential, incidental or special damages resulting from or related in any manner to any American Rotary product, third party installation(s), manufactured or distributed, or parts thereof. A licensed electrician must perform all installations. Not all American Rotary motor starters are UL listed. This is an option the customer must specify and additional charges will apply. American Rotary is not responsible for meeting, complying with or insuring installation inspections. American Rotary does not accept returns on units that have been installed or energized.

NOTE

Installations must comply with all national and local electrical code requirements and must be installed by a qualified licensed electrician. Warranty is non-transferable and will remain with original purchaser/end user.